

# GIGALAB-II



*Digital multivoltage mega-ohmmeter*  
**Measuring range:**

10V from 1KΩ to 50GΩ  
 100V from 100KΩ to 1TΩ  
 250V from 500KΩ to 1TΩ  
 500V from 1MΩ to 1TΩ

**Accuracy**

10V ±5% ±0.6% per GΩ  
 100V ±5% ±0.06% per GΩ  
 250V ±5% ±0.045% per GΩ  
 500V ±5% ±0.03% per GΩ

**Fully settable acoustic alarm**

**Connectable to shielded probe**

## Description

GIGALAB is a digital mega-ohmmeter that can measure the point to point resistance at 10, 100, 250, 500V. The test voltage is selectable by the user and is always displayed on the bottom of the display with the light/up of the correspondent green led.

Measuring range is:

10V from 1KΩ to 50GΩ  
 100V from 100KΩ to 1TΩ  
 250V from 500KΩ to 1TΩ  
 500V from 1MΩ to 1TΩ

Accuracy is normally 5% and the value of the measure is always displayed with 3 significant figures. It's possible to program the display reading in natural or exponential format.

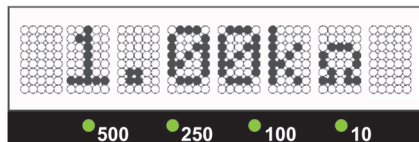

Natural

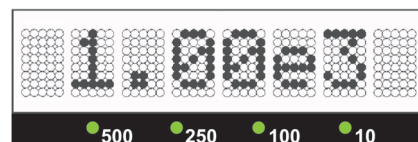

Exponential

An acoustic alarm can be programmed to be activate when:

- resistance of measure is higher than the selected value
- resistance of measure is lower than the selected value
- resistance of measure is between two selected values
- resistance of measure is not between two selected values

GIGALAB can be connected to shielded probes to eliminates the usual noise providing ease of operation even at very high resistance values.

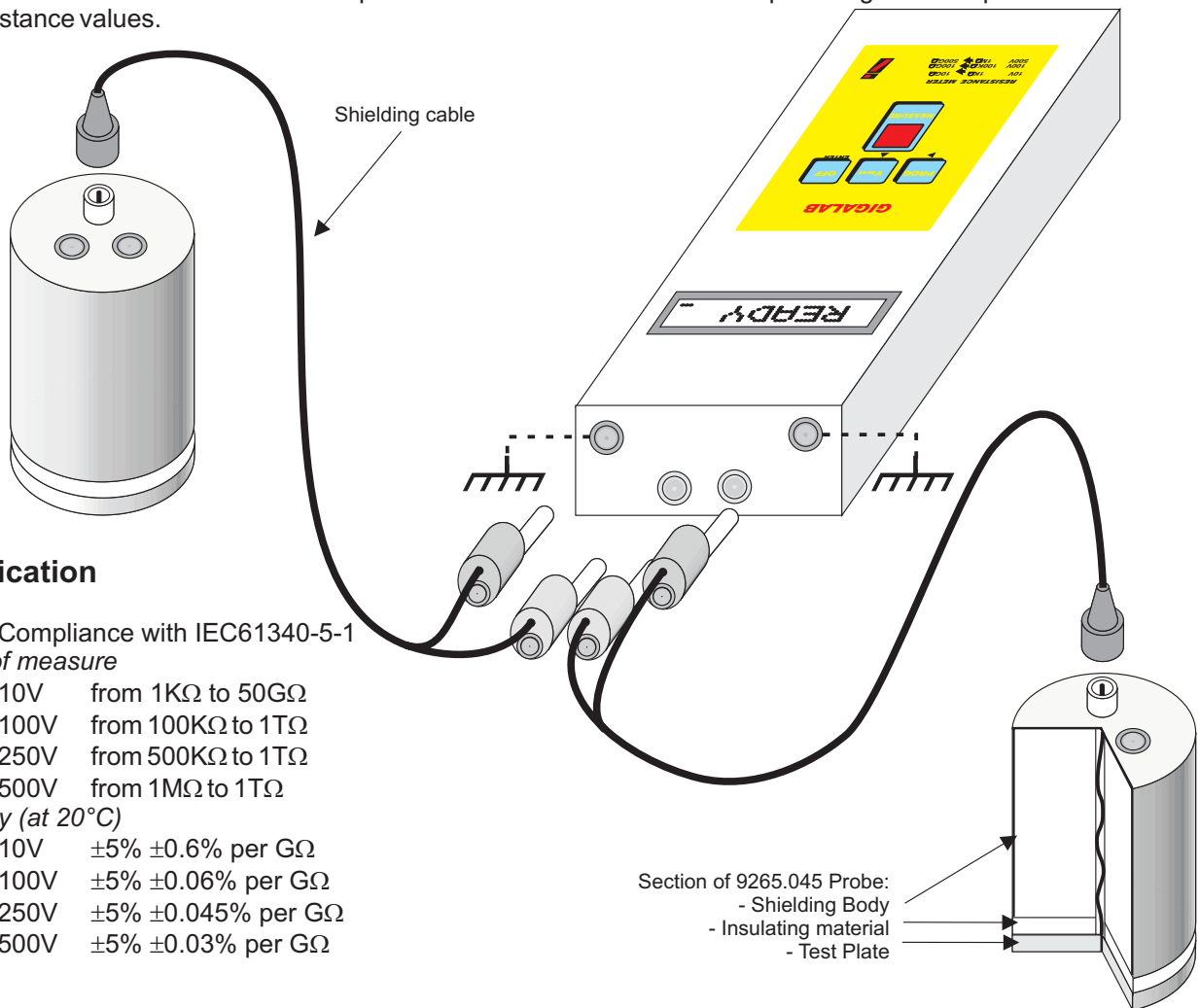

## Specification

### Safety

Compliance with IEC61340-5-1

### Range of measure

10V	from 1K $\Omega$ to 50G $\Omega$
100V	from 100K $\Omega$ to 1T $\Omega$
250V	from 500K $\Omega$ to 1T $\Omega$
500V	from 1M $\Omega$ to 1T $\Omega$

### Accuracy (at 20°C)

10V	$\pm 5\% \pm 0.6\%$ per G $\Omega$
100V	$\pm 5\% \pm 0.06\%$ per G $\Omega$
250V	$\pm 5\% \pm 0.045\%$ per G $\Omega$
500V	$\pm 5\% \pm 0.03\%$ per G $\Omega$

Section of 9265.045 Probe:  
 - Shielding Body  
 - Insulating material  
 - Test Plate

**Resolution** 3 significant figures always on display

**Operating range** From 0 to 40°C

**Operating humidity** Max 85%

**Battery** 6 x 1,5V IEC LR6 type only

**Battery life** About 2000 measuring operations at 500V of 15 seconds each

GIGALAB write "LOWBAT" on the display when the voltage of the 6 batteries is lower tha 7.4V  
 When the instrument is in "LOW BATTERY" it's only possible to measure at 10V

**Auto Shut-Off** After 4 minutes of no activity the instruments shut-off

**Fusibile** 250mA

**Display** 8 alphanumerical carachters, 48 x 12mm with 11mm height carachters

**Dimensions** 92 x 218 x 38mm (L x H x P)

**Weight** 450g

- 9265.043** GIGALAB Meter with 2 shielded cables, batteries and case
- 9265.044** GIGALAB complete kit including meter, 2 shielded probes, 2 shielded cables, batteries and case
- 9265.045** Shielded probe 63mm / 2,3Kg, with two 4mm socket and one BNC socket, Blue
- 9265.004B** Cylindrical probe, one 4mm socket, Black
- 9265.004R** Cylindrical probe, one 4mm socket, Red
- 9265.005** Concentric ring probe kit, one BNC socket, Black