

pneumatic  
cutting  
forming machine  
for loose radial  
components

# TP/TS1 TP/SC4

macchina  
pneumatica  
taglia forma  
componenti  
radiali sfusi

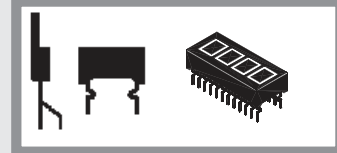
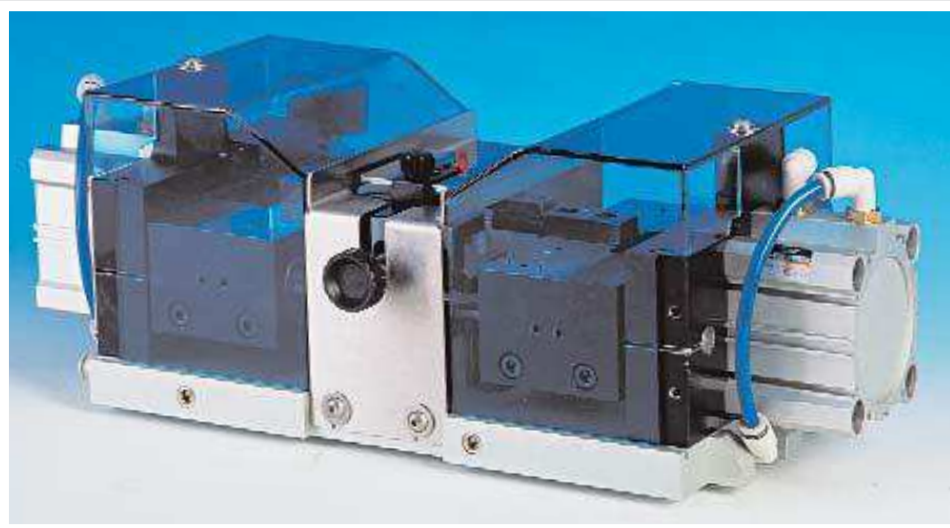

LENGTH = 39 cm  
WIDTH = 23 cm  
HEIGHT = 14 cm  
PACKING = 45x40x27 cm  
VOLUME = 0,0486 m<sup>3</sup>  
MACHINE WEIGHT = 13 kg  
GROSS WEIGHT = 14 kg

LUNG. = 39 cm  
LARGH. = 23 cm  
ALT. = 14 cm  
IMBALLO = 45x40x27 cm  
VOLUME = 0,0486 m<sup>3</sup>  
PESO MACCHINA = 13 kg  
PESO LORDO = 14 kg

TP/TS1 18.0000  
Standard without forming die  
Standard senza matrici

LEAD DIA. = 0,3-1,2 mm.(.011-.047)  
PRODUCTION = 2.000 p/h  
DIAM. REOFORO = 0,3-1,2mm.  
PRODUZIONE = 2.000 p/h

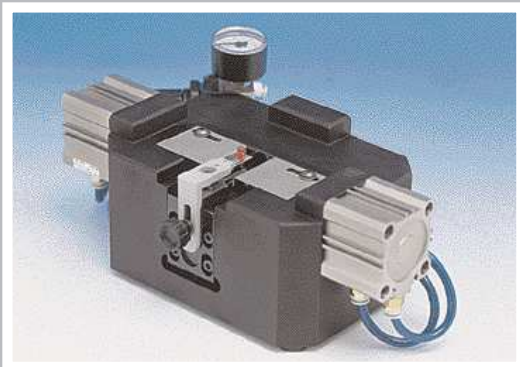

TP/SC4 16.0000  
Standard 2 cylinders  
without forming die

Standard 2 cilindri  
senza matrici

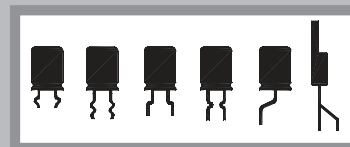

LEAD DIA. = 0,3 - 0,8mm (.011-.031")  
PRODUCTION = 2.000 p/h  
DIAM. REOFORO = 0,3 - 0,8 mm  
PRODUZIONE = 2.000 p/h

LENGTH = 27 cm  
WIDTH = 24 cm  
HEIGHT = 11 cm  
PACKING = 39x25x27 cm  
VOLUME = 0,034 m<sup>3</sup>  
MACHINE WEIGHT = 8 kg  
GROSS WEIGHT = 10 kg

LUNG. = 27 cm  
LARGH. = 24 cm  
ALT. = 11 cm  
IMBALLO = 39x25x27 cm  
VOLUME = 0,034 m<sup>3</sup>  
PESO MACCHINA = 8 kg  
PESO LORDO = 10 kg

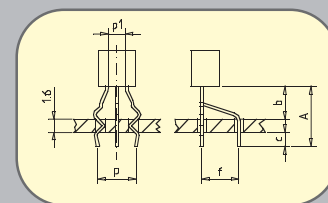

\*= quote to be specified upon order  
\*= quota da comunicare all'ordine

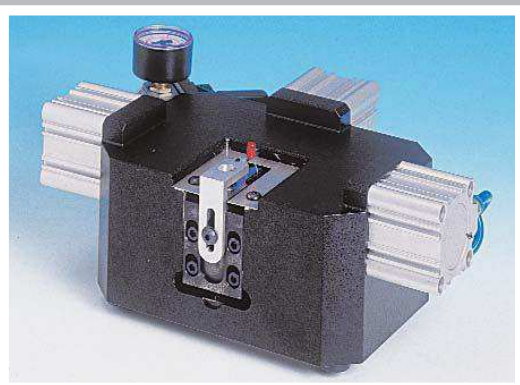

TP/SC4 16.0100  
3 cylinders without forming die  
3 cilindri senza matrici

163000  
CENTER LEAD SPREAD -  
DOUBLE KINK ON OUTER  
LEADS  
ONLY SUPPLIED WITH TP/SC4  
COD. 16.0100  
REOFORO CENTRALE SPOSTA-  
TO - DOPPIA ANSA SU REOFORI  
ESTERNI DIVARICATI  
SOLO FORNITO CON TP/SC4  
COD. 16.0100

	MM			IN		
	min	max	fix	min	max	fix
<b>A*</b>			6,1			.24
<b>b*</b>			3			.122
<b>c*</b>			1,5			.059
<b>f*</b>			2,54			.1
<b>p*</b>			5,08			.2
<b>p1*</b>			2,54			.1

## forms realised with special die assemblies

## forme realizzate con matrici speciali



The pneumatic machines TP/TS1 and TP/SC4 are very flexible equipment designed for cutting and forming loose radial components. A large number of dies are designed and manufactured to realise the mainly requested standard forms and special ones. They can be adapted to both machine apart one (163000) which needs the activation of a third cylinder that can only be with TP/SC4. It is possible to equip both machines, on request, with two wire holders in order to lock the leads between the body and the operation area.

Le macchine pneumatiche TP/TS1 e TP/SC4 sono attrezzature estremamente versatili adatte al taglio e la formatura di componenti radiali sfusi. Un grande numero di matrici sono state progettate per realizzare forme standard maggiormente richieste e soprattutto forme speciali. Esse possono adattarsi ad entrambe le macchine ad esclusione di una (163000) che richiede l'attivazione di un terzo cilindro solo applicabile al modello TP/SC4, su entrambe le macchine è possibile utilizzare, a richiesta, due premifili per bloccare i reofori tra il corpo e la zona di preformatura.

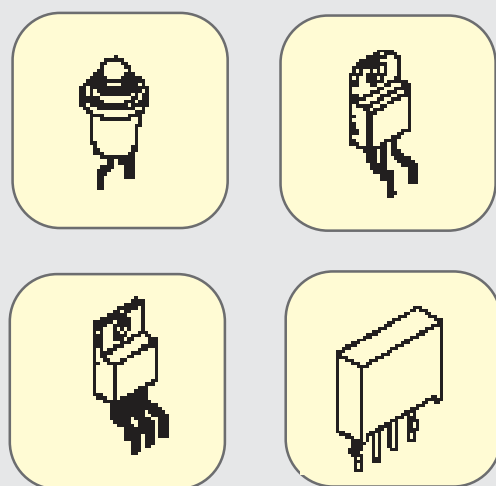

Sturdy reliable and long lasting equipment  
Attrezzatura forte e fatta per durare nel tempo

Ease of set up and use  
facilità di regolazione ed uso

No maintenance needed  
non richiede manutenzione

# die assemblies for TP/SC4 and TP/TS1 machines

# gruppi matrici per le macchine TP/SC4 e TP/TS1

160600/180600  
STAND OFF-LOCK IN/DOUBLE KINK  
DOPPIA ANSA/BLOCCAGGIO SU SCHEDASTAND  
P:=2,54 - 5,08 - 7,62 - 10,16 mm (.1 - .2 - .3 - .4")

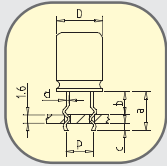

	MM			IN		
	min	max	fix	min	max	fix
<b>a</b>	5	15		.196	.590	
<b>b</b>	2	12		.078	.472	
<b>c</b>			1,4			.055
<b>d</b>	0,4	0,8		.015	.031	
<b>D</b>	1	15		.039	.590	

161100/181100  
DIODE BRIDGE 4 LEADS  
PONTE DIODO A 4 REOFORI  
P.5,08 mm (.2")

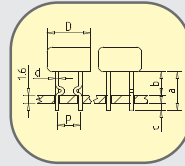

	MM			IN		
	min	max	fix	min	max	fix
<b>a</b>	6	14		.236	.551	
<b>b</b>	4	12		.157	.472	
<b>c</b>			1,4			.055
<b>d</b>	0,4	0,8		.015	.031	
<b>D</b>	1	15		.039	.590	

160700/180700  
STAND OFF-LOCK IN LED/DOUBLE KINK  
DOPPIA ANSA LED/BLOCCAGGIO SU SCHEDA  
P.2,54 mm (.1")

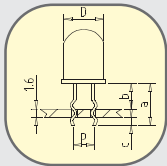

	MM			IN		
	min	max	fix	min	max	fix
<b>a</b>	5	15		.196	.590	
<b>b</b>	2	12		.078	.472	
<b>c</b>			1,4			.055
<b>D</b>	2	5		.078	.196	

161200/181200  
POLARITY  
POLARITA'  
P.2,54 mm (.1")

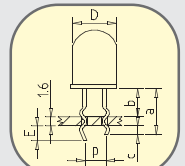

	MM			IN		
	min	max	fix	min	max	fix
<b>a</b>	5	15		.196	.590	
<b>b</b>	2	12		.078	.472	
<b>c</b>			1,4			.055
<b>D</b>	2	5		.078	.196	
<b>E</b>		2,4				.094

160800/180800  
STAND OFF-KINK OUTWARD  
ANSA ESTERNA IN APPOGGIO SU SCHEDA  
P:=2 - 2,54 - 5,08 - 7,62 - 10,16 mm (.78 - .1 - .2 - .3 - .4")

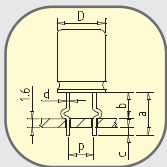

	MM			IN		
	min	max	fix	min	max	fix
<b>a</b>	6	16		.236	.629	
<b>b</b>	3	13		.118	.511	
<b>c</b>			1,4			.055
<b>d</b>	0,4	0,8		.015	.031	
<b>D</b>	1	15		.039	.590	

161300/181300  
90° BENDING  
PIEGA A 90°

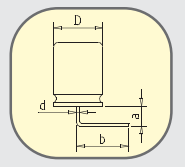

	MM			IN		
	min	max	fix	min	max	fix
<b>a</b>	3	8		.118	.314	
<b>b*</b>			6			.236
<b>d*</b>	0,4	0,8		.015	.031	
<b>D*</b>	1	15		.039	.590	

160900/180900  
BODY LOCKED ON P.C.BOARD  
CORPO A BATTUTA/BLOCCAGGIO SU SCHEDA  
P:=2,54 - 5,08 - 7,62 - 10,16 mm (.1 - .2 - .3 - .4")

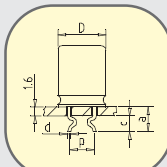

	MM			IN		
	min	max	fix	min	max	fix
<b>a</b>			3			.118
<b>c</b>			1,4			.055
<b>d</b>	0,4	0,8		.015	.031	
<b>D</b>	1	15		.039	.590	

161400/181400  
SURFACE MOUNTING  
MONTAGGIO IN SUPERFICIE

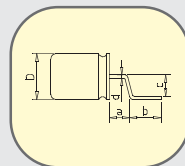

	MM			IN		
	min	max	fix	min	max	fix
<b>a</b>	2,5	8		.098	.314	
<b>b*</b>			2			.078
<b>c*</b>			2,5			.098
<b>d*</b>	0,4	0,8		.015	.031	
<b>D*</b>	1	15		.039	.590	

161000/181000  
STRAIGHT CUT  
SOLO TAGLIO  
P:=2,54 - 5,08 - 7,62 - 10,16 mm (.1 - .2 - .3 - .4")

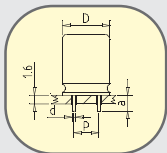

	MM			IN		
	min	max	fix	min	max	fix
<b>a</b>	3	13		.118	.511	
<b>d</b>	0,4	0,8		.015	.031	
<b>D</b>	1	15		.039	.590	

161500/181500  
STAND OFF/KINK INWARD  
APPOGGIO ANSA INTERNA  
P:=2 - 2,54 - 5,08 - 7,62 - 10,16 mm (.78 - .1 - .2 - .3 - .4)

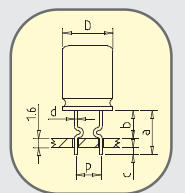

	MM			IN		
	min	max	fix	min	max	fix
<b>a</b>	6	16		.236	.629	
<b>b</b>	3	13		.118	.511	
<b>c</b>			1,4			.055
<b>d</b>	0,4	0,8		.015	.031	
<b>D</b>	1	15		.039	.590	

161700/181700  
TO SPREAD OUT AND CUT  
CAMBIO PASSO IN AUMENTO

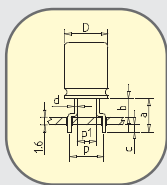

	MM			IN		
	min	max	fix	min	max	fix
<b>a</b>	5	8		.196	.314	
<b>b</b>	2	5		.078	.196	
<b>c</b>			1,4			.055
<b>d*</b>	0,4	0,8		.015	.031	
<b>D</b>	1	15		.039	.590	
<b>p1*</b>			2,54			.1
<b>p*</b>			5,08			.2

161800/181800  
TO REDUCE PITCH AND CUT  
CAMBIO PASSO IN DIMINUZIONE

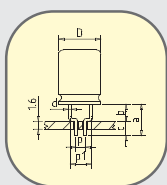

	MM			IN		
	min	max	fix	min	max	fix
<b>a</b>	5	8		.196	.314	
<b>b</b>	2	5		.078	.196	
<b>c</b>			1,4			.055
<b>d*</b>	0,4	0,8		.015	.031	
<b>D</b>	1	15		.039	.590	
<b>p1*</b>			5,08			.2
<b>p*</b>			2,54			.1

162100/182100  
TO-220 CENTRAL LEAD SPREAD AND CUT  
TO-220 REOFORO CENTRALE SPOSTATO

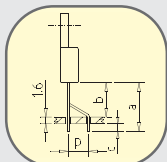

	MM			IN		
	min	max	fix	min	max	fix
<b>a</b>	7	13		.275	.511	
<b>b</b>	4	10		.157	.393	
<b>c</b>			1,4			.055
<b>p*</b>			2,54			.1

162200/182200  
TO-220 CENTER LEAD SPREAD AND LOCK  
TO-220 REOFORO CENTRALE SPOSTATO E ANSA BLOCCAGGIO

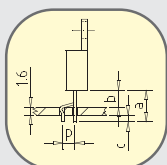

	MM			IN		
	min	max	fix	min	max	fix
<b>a</b>	7	13		.275	.511	
<b>b</b>	4	10		.157	.393	
<b>c</b>			1,4			.055
<b>p*</b>			2,54			.1

162300/182300  
TO-220 CENTER LEAD SPREAD/3 LEAD LOCK  
TO-220 REOFORO CENTRALE SPOSTATO/DOPPIA ANSA SU TRE REOFORI

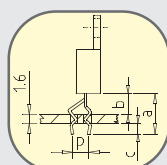

	MM			IN		
	min	max	fix	min	max	fix
<b>a</b>	7	13		.275	.511	
<b>b</b>	4	10		.157	.393	
<b>c</b>			1,4			.055
<b>p*</b>			2,54			.1

\*quote to be specified upon order  
\*quota da comunicare all'ordine

162400/182400  
TO-220 DOUBLE KINK ON THREE LEAD - IN LINE  
TO-220 DOPPIA ANSA SU TRE REOFORI IN LINEA

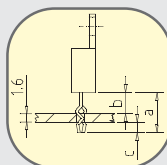

	MM			IN		
	min	max	fix	min	max	fix
<b>a</b>	6	11		.236	.433	
<b>b</b>	3	8		.118	.314	
<b>c</b>			1,4			.055

162500/182500  
TO-92 CENTER LEAD SPREAD  
TO-92 REOFORO CENTRALE SPOSTATO

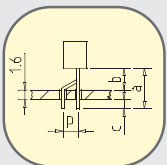

	MM			IN		
	min	max	fix	min	max	fix
<b>a</b>	7	13		.275	.511	
<b>b</b>	4	10		.157	.393	
<b>c</b>			1,4			.055
<b>p*</b>			1,27			.05

162600/182600  
TO-92 CENTER LEAD SPREAD AND LOCK  
TO-92 REOFORO CENTRALE SPOSTATO/  
ANSA BLOCCAGGIO

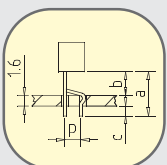

	MM			IN		
	min	max	fix	min	max	fix
<b>a</b>	7	13		.275	.511	
<b>b</b>	4	10		.157	.393	
<b>c</b>			1,4			.055
<b>p*</b>			1,27			.05

162700/182700  
TO-92 CENTER LEAD SPREAD/THREE LEAD LOCK  
TO-92 REOFORO CENTRALE SPOSTATO/DOPPIA ANSA SU TRE REOFORI

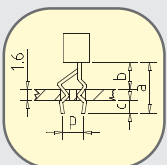

	MM			IN		
	min	max	fix	min	max	fix
<b>a</b>	7	13		.275	.511	
<b>b</b>	4	10		.157	.393	
<b>c</b>			1,4			.055
<b>p*</b>			1,27			.05

162800/182800  
TO-92 STAND OFF-LOCK IN/THREE LEAD IN LINE  
TO-92 DOPPIA ANSA SU TRE REOFORI/IN LINEA

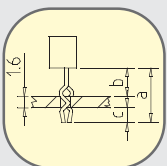

	MM			IN		
	min	max	fix	min	max	fix
<b>a</b>	6	11		.236	.433	
<b>b</b>	3	8		.118	.314	
<b>c</b>			1,4			.055

163100/183100  
TO-220 90° BENDING CENTER LEAD OFF SET  
TO-220 PIEGA 90° REOFORO CENTRALE SPOSTATO

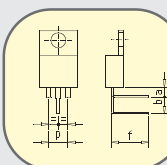

	MM			IN		
	min	max	fix	min	max	fix
<b>a</b>	3	5		.118	.196	
<b>b*</b>			5			.196
<b>f*</b>			6			.216
<b>p</b>			5,08			.2